

Lone Star Leadership Academy – Youth Facilitator Austin/San Antonio

Drop-Off on Sunday

Location: Education in Action
16000 Ranch Road 12
Wimberley, TX 78676

When you arrive:

- Bring your luggage inside.
- If you are turning in medication, have it ready (separate from your luggage).

Time: 3:00 PM

Contact Information

If you have any questions on Sunday, call the emergency cell phone number to speak with the camp director. If you cannot reach the director, call the office cell phone.

Camp Director/Emergency Cell Phone: 817-793-8300

Office Cell Phone: 817-703-2287

Transportation Changes

Requests to add the charter bus transportation option must be made **in writing** and no later than **two Fridays (nine calendar days) prior to the camp start date.**

Driving Directions*

**Education in Action recommends that you plan your route prior to departing for drop-off.*

From Dallas

Take IH-35 S. Take exit #230 and merge onto US-290 W in Austin. After about 20 miles, turn left onto Ranch Road 12 and continue for 12.6 miles. The last major intersection will be Winter's Mill Pkwy. Education in Action is about ½ mile further on the left, directly across from a white water tower. The front of the building resembles a house with a small porch. If you reach downtown Wimberley, you have gone about 3 miles too far.

From Houston

Take I-10 west toward San Antonio. Take exit #632 and merge onto US-183 N. In Luling, turn right onto S Magnolia Ave. and then take the 3rd left onto TX-80 N/E Austin St. After passing I-35, turn right onto Moore St./Ranch Road 12 and continue for about 16 miles. Education in Action is about 3 miles past downtown Wimberley on the right, directly across from a white water tower. The front of the building resembles a house with a small porch. If you reach Winter's Mill Pkwy., you have gone about ½ mile too far.

From West Texas

Take Highway 71 east towards Austin. Turn right on FM 3238/Hamilton Pool Rd. and continue for 6.7 miles. Turn left onto Brooks Ranch Road/Ranch Road 12 and continue for 20 miles. The last major intersection will be Winter's Mill Pkwy. Education in Action is about ½ mile further on the left, directly across from a white water tower. The front of the building resembles a house with a small porch. If you reach downtown Wimberley, you have gone about 3 miles too far.

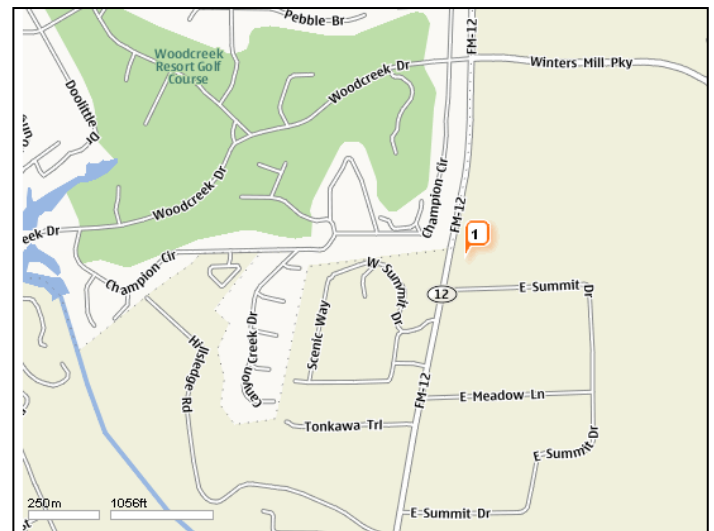
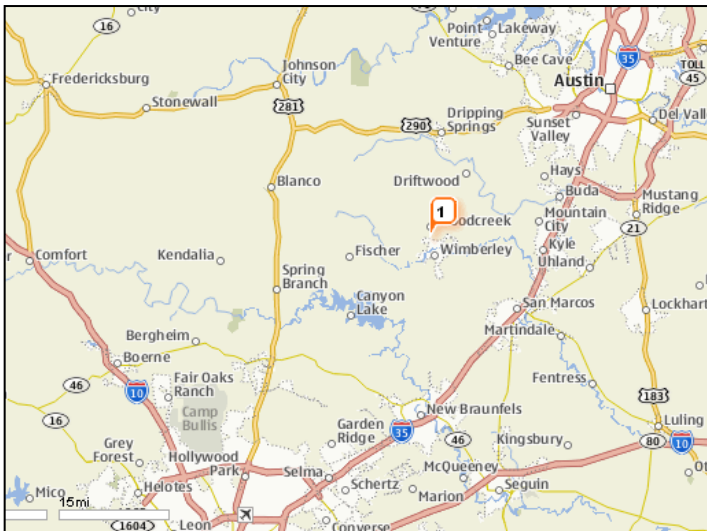

Lone Star Leadership Academy – Youth Facilitator

Austin/San Antonio

Pick-Up on Friday

Location: Stephen F. Austin State Office Bldg.
Room 170
 1700 Congress Ave.
 Austin, TX 78701

Time: 12:15 PM

Parking: Parking is available in the Bullock Texas State History Museum parking garage on 18th Street for \$8.00. There is also curbside, metered parking in and around the area (along Congress Avenue or 18th Street).

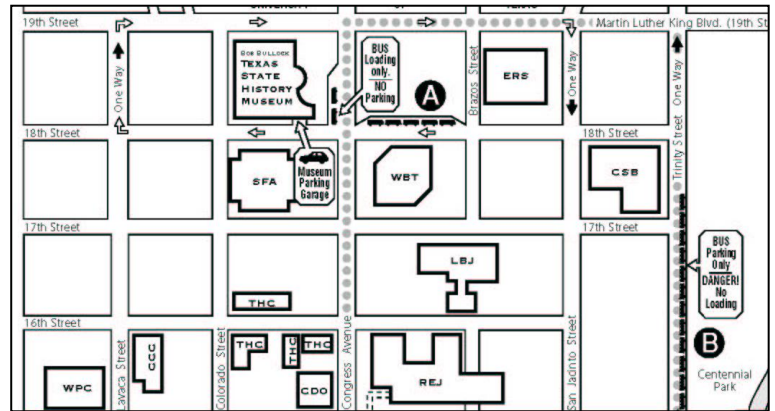

Driving Directions*

*Education in Action recommends that you plan your route prior to departing for pick-up.

From Dallas

Take I-35E S toward Waco. Merge onto I-35 S/US-81 S via the left exit. Once you enter Austin, take the exit toward MLK Blvd./ 15th Street. Turn right onto E. Martin Luther King Jr. Blvd. Turn left onto Congress Avenue.

From Houston

Take I-10 west to Columbus and exit onto Highway 71 traveling west towards La Grange/Austin. Merge onto I-35 N/US-81 N. Once you enter Austin, take the exit toward 15th Street/MLK Blvd./State Capitol. Turn left on E. 15th Street. Turn right on Congress Avenue.

From West Texas

Take I-20 E. Merge onto US-83 S/US-84 E toward Ballinger/Coleman/San Angelo. Merge onto US-183 S. Merge onto I-35 S/US-81 S. Once you enter Austin, take the exit toward MLK Blvd./ 15th Street. Turn right onto E. Martin Luther King Jr. Blvd. Turn left onto Congress Avenue.

